

8 1/2 " (21 cm) Max

9 " (24 cm) Max

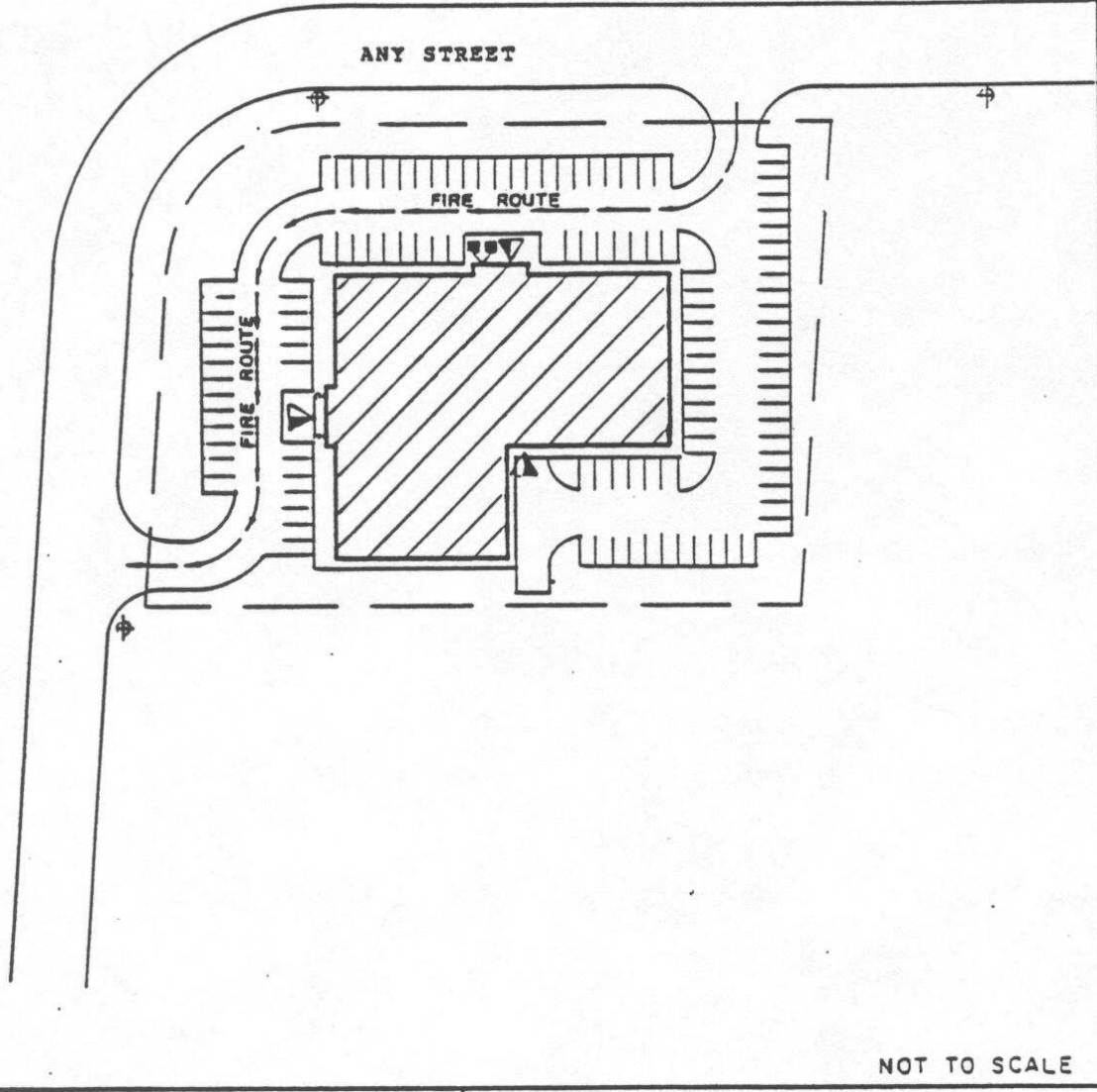

**LEGEND**

APPROXIMATE LOCATION OF PROPERTY LINE

FIRE ROUTE SHOWN AS

FIRE ROUTE SIGN ON STREETLIGHT POLE

FIRE ROUTE SIGN ON SIGN POST

FIRE ROUTE SIGN ON BUILDING OR STRUCTURE

ENTRANCE TO BUILDING

FIRE (SIAMESE) CONNECTION

FIRE HYDRANT

NO STOPPING NO PARKING

BACK MOUNTED END MOUNTED

BACK MOUNTED END MOUNTED

BACK MOUNTED END MOUNTED

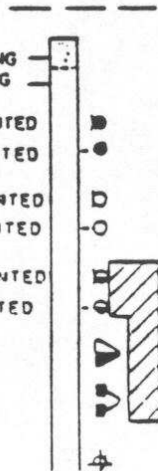

**DRAWING NUMBER**

DESIGNATED FIRE ROUTE



**SIGNING**

COST: N/A		SIGNING	
TYPE	No	TYPE	No
FR-1		FR-5	
FR-2		FR-6	
FR-3		FR-7	
FR-4		FR-8	

ADVISORY

**LOCATION**

123 ANY STREET